

2010 Winter Camporee



Lewis & Clark District
Mid America Council, B.S.A.

January 22-24, 2010

Bellevue Rod and Gun Club

Schedule:

Friday

- 5:00 – 8:00 pm Check-in at Clubhouse and set up camp
Turn in Troop roster, show current Health Forms and Tour Permit
- 8:00 pm Shooting Safety Briefing – required for all who want to shoot.
- 8:30 pm Scoutmaster and SPL meeting/cracker barrel at Clubhouse.
Movie at Clubhouse (open to all).
- 10:30 pm Lights Out

Saturday

- 7:00 am Reveille
- 7:00 – 8:00 am Breakfast in the Clubhouse.
- 8:30 am Flag Ceremony and Roll Call at main Flag Pole
- 9:00 – Noon Program Activities
- Noon – 1:00 pm Lunch in the Clubhouse
- 1:00 – 4:00 pm Program Activities
- 4:00 – 5:00 pm Scout-Athalon
Leader Shotgun Shoot-off
- 5:30 pm Flag retreat at main Flag Pole
- 5:45 pm Activity scorecards due (turn in at Clubhouse)
- 5:45 – 6:30 pm Dinner in the Clubhouse
- 6:30 – 7:00 pm Clean-up
- 7:00 pm Scouts Own – Worship service
- 7:30 pm Evening Campfire and Awards presentation in Clubhouse
- 8:30 pm Scoutmaster and SPL meeting/cracker barrel at Clubhouse.
Movie at Clubhouse (open to all).
- 10:30 pm Lights Out

Sunday

- 7:00 – 8:00 am Reveille and Breakfast in at Clubhouse
- 8:00 – 10:00 am Checkout (units must checkout with staff)
- 10:00 am Camp Closed

Important Information

Registration & Fees

Registration is open to all Boy Scouts, Explorers, and Venture Crews for the entire weekend. Registration includes access to all events, four hot meals, and a Camporee patch. The cost is \$20 per person. There is no discount for daytime only participants. Registrations received after 1/16/2010 DO NOT include meals.

Tour Permits & Health Forms

Tour Permits and current Health Forms MUST accompany all units to the Camporee. They will be verified at check-in.

Parking

Please be courteous when parking your vehicles to ensure they are in designated parking areas. **SCOUTS AND SCOUTERS ARE NOT ALLOWED TO RIDE IN THE BED OF A PICKUP TRUCK FOR ANY REASON.**

Check-In Procedure

Please plan to arrive at the Bellevue Rod and Gun Club between 5:00 pm and 8:00 pm Friday evening. Check-in will be at the Clubhouse. Please have your Tour Permit and Health Forms for verification and turn in your Unit Roster that time. You will be assigned a camping space at check-in.

Straw

Straw will NOT be allowed as ground insulation. All material used for ground insulation must be removed and taken with you. NOTE: This is a leave no trace campout. Pack out everything you brought in.

Ground Fires

You must obtain permission for, and instructions on, ground fires from a Bellevue Rod & Gun club member. Above ground fires will be allowed.

Restrooms

Portable restrooms will be provided for the Camporee. The indoor restrooms are reserved for staff only. The club's septic system is unable to handle the load of 200+ campers.

Check Out Procedure

The Camporee Staff will be located in the Clubhouse for check-out. You must be out of the Rod & Gun Club by 10:00 am. Please POLICE your campsite area before you leave. All material used for ground insulation must be removed and taken with you.

Medical/Emergency

Dennis Bender, a trained EMT, will be present throughout the weekend in the clubhouse in the event that first aid or emergency medical treatment is required.

Events

Our events will be broken down into 3 categories; First Aid/Safety, Scout Craft/Skill and Team Building. Our tentative event list is below

Patrol Competition – Activity Card

Each Patrol/Unit will be given an Activity Card that they will be responsible for carrying to each event or activity. The Staff member at each event will write a score for that event on the Activity Card along with his/her signature. Please turn your Activity Card in at CLOSING FLAGS to be tallied by the Staff when you come for Dinner. The top three scoring Units or Patrols will be announced at the Evening Campfire.

Stretcher Carry/Relay

Scouts will construct a stretcher and carry a Scout a certain distance then switching another Scout in a relay fashion until they carry 4 Scouts. Points will be awarded for speed and creativity on the stretcher design and extra points for good team work.

Ladder Climb

Using ropes and spars provided, the patrol must lash together a ladder. A Scout then climbs to the top and grabs a flag from a tree. This is a timed event with points given for quality of lashings and teamwork

Compass Bearing

All members of the patrol sight on an object and report collectively on its bearing; and lay off a bearing and report the object on the bearing. This event may also require a patrol to use a compass to orient a topographic map.

First Aid and Survival Kit Inspection

Each sled should have a patrol first aid kit. Each Scout should have a BP Kit (emergency/first aid kit) in their knapsack. At the station, the patrol kit and several individuals' kits are examined and Scouts asked to comment on the use of various items.

First Aid: Split and Transport

Each patrol is required to care for a casualty with a broken leg or arm. After splinting, place the casualty correctly on sled for transport. Patrols are responsible for bringing the needed supplies. Extra points awarded for different methods of transport.

Emergency Shelter

The patrol must construct an emergency shelter using only the items they have on their sled/person. Teams must locate a suitable spot given the current conditions, which will be given by the event staff. They must work together to get into the shelter as quickly as possible. Points will be given for creativity and teamwork, bonus points for correct use of knots and lashings.

Ice Rescue

Each Scout throws a rope to a "victim" who has "fallen through the ice" and retrieves same. Patrol may be asked to demonstrate other forms of ice rescue. Cub Scouts will be the "victims" and will be quizzed on cold weather safety and how to prepare for cold weather outings

Group Knot Tying

Patrols all hold a rope and must work together to tie a commonly used Scouting knot. The event staff will give each group their knot assignment. Points will be given for speed and good communication between team members.

Smooshboard Race

Patrol members' right feet are tied to one long 2x4; left feet to another. Patrol is timed in walking a course on flat ground.

Snow Shoe Relay

Patrol members are divided up into 2 teams. A member from each team must race to his team member with one snow shoe on then untie it and give it to his team member who races back, the first team to have all members' race wins.

Panning for Gold

Patrol uses a tarp co-operatively to toss a "nugget" over a horizontal rope 3 m above the ground. The event is scored by counting the number of consecutive times the nugget gets over the rope within the time limit.

22 Shoot

Each Scout will be given a chance to practice their marksman ship using a 22 rifle.

Shotgun Trap Shoot

Each Scout will be given a chance to practice their trap shooting abilities.

Cook-Off Competition

There will be a Dessert Cook-Off for the Scouts. The cook-off entries will be served "pot-luck" at the evening meal. Scout dessert entries need to bring enough for their patrol plus 2. Troops participating will be allowed to eat before non-participating Troops.

"Be Prepared" for Winter Safety – Don't Get Left Out in the C.O.L.D.

The most common errors people make during cold-weather activities include not eating the right kinds of foods, not drinking enough water, not having adequate clothing, and being unaware of the signs of frostbite. One of the best ways to remember what is appropriate to eat when you are spending extended periods of time outside in cold weather is to use good nutrition to "build the fire within". Make sure your food consumption includes sugars, which act like a fire starter, carbohydrates and proteins, which act as kindling, and fats that produce the energy needed to keep the fire burning and your body running at peak performance. Stay away from caffeinated drinks such as soda, coffee, and tea; drink plenty of plain water or sports drinks to keep yourself properly hydrated.

To avoid these and other similar safety hazards this season, the BSA is sharing its tried-and-true winter safety tips. These commonsense tips can help winter campers, skiers, outdoor enthusiasts, and families who make highway travel plans to "be prepared" for winter hazards.

TOP OUTDOOR SAFETY TIPS FOR THE C-O-L-D

Keeping warm is the most important part of cold-weather camping and outdoor activities. Use the C-O-L-D method to stay warm.

C - Clean

Since insulation is only effective when heat is trapped by dead air spaces, keep your insulating layers clean and fluffy. Dirt, grime, and perspiration can mat down those air spaces and reduce the warmth of a garment.

O - Overheating

Avoid overheating by adjusting the layers of your clothing to meet the outside temperature and the exertions of your activities. Stay hydrated by drinking plenty of water, and refrain from drinking caffeinated drinks that act as diuretics.

L - Loose Layers

A steady flow of warm blood is essential to keep all parts of your body heated. Wear several loosely fitting layers of clothing and footgear that will allow maximum insulation without impeding your circulation. Having clothing that is bright colored (orange or red) is also a good idea, so hunters and sportsmen can see you in snowy conditions. Always have a hat and wear it.

D - Dry

Sweaty, damp clothing and skin can cause your body to cool quickly, possibly leading to frostbite and hypothermia. Keep dry by avoiding clothes that absorb moisture. Always brush away snow on your clothes before you enter a heated area. Keep clothing around your neck loosened so that body heat and moisture can escape instead of soaking through your layers. Keep your socks dry.

Directions to the Bellevue Rod & Gun Club

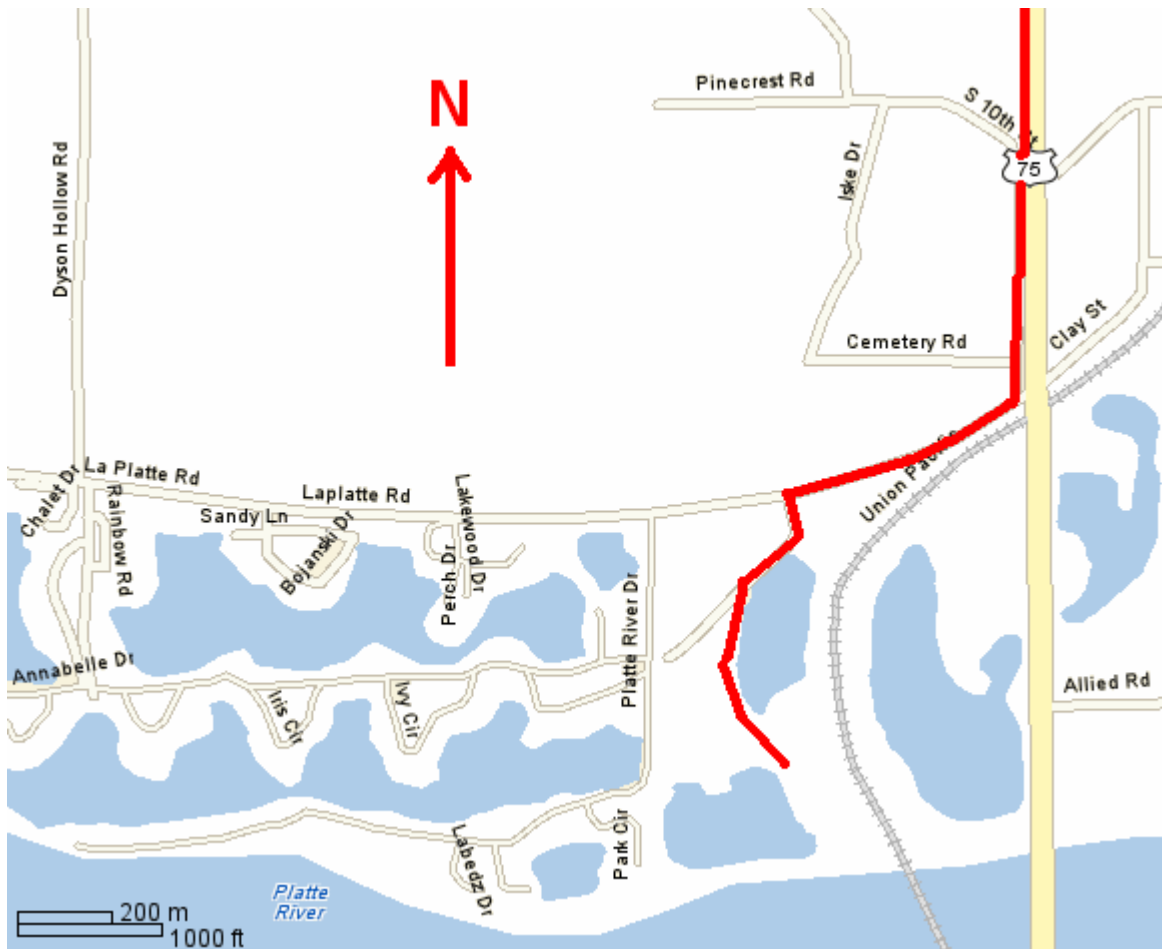

1. Take US 75 South to La Platte Rd.
2. Turn Right on La Platte Rd and follow it South to a T intersection.
3. Turn Right onto La Platte Rd, follow it for approximately ½ mile.
4. Bellevue Rod & Gun Club is on the South (Left) side of the road – watch for the sign.
5. Follow the driveway around the right side of the lake, turn left at the fork in the driveway.

Unit Roster

(This form must be turned in at Check-In)

Unit _____ Home District _____

Scoutmaster _____ Cell Phone # _____

Scouts (youth) and Scouters (adults) Attending

	Name (Last, First)	Youth / Adult Rank / Position	Current Health Form
1.			
2.			
3.			
4.			
5.			
6.			
7.			
8.			
9.			
10.			
11.			
12.			
13.			
14.			
15.			
16.			
17.			
18.			
19.			
20.			

Lewis & Clark District

2010

Winter Camporee

January 22-24, 2010
at the
Bellevue Rod and Gun Club

Unit Registration Form



Troop # _____

Scoutmaster _____

Phone _____

E-mail _____

Registration Fees:

Total Youth _____ @ \$20.00 \$ _____

Total Adults _____ @ \$20.00 \$ _____

Total Paid \$ _____

NOTE: Fees include the Camporee and four hot meals for the weekend served inside. Registrations received after January 16th, 2010 DO NOT include meals. No discount for daytime only participants.

All troops are responsible for carrying current medical forms for all Scouts. We recommend each Scout carry a copy of their form in a plastic bag on their person at all times.

All Troops are responsible for filing a Tour Permit with Scouter Services at the Durham Scout Center at 124th and West Maple Road, Omaha.

No Troop will be allowed at the Camporee without a completed Unit Roster.

Questions? Contact Bill Stott at 551-3400 or bstott@thearchitecturaloffices.com